

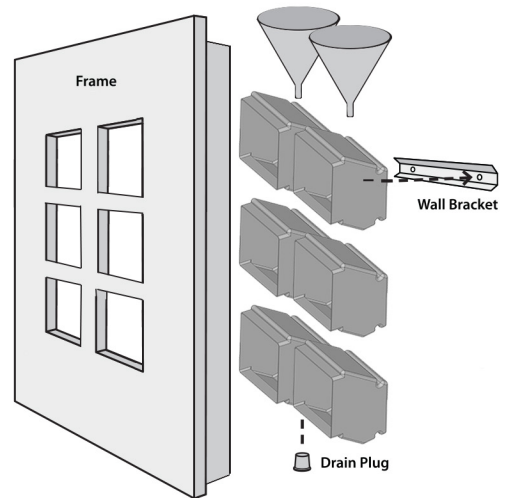

# Shop Living Wall

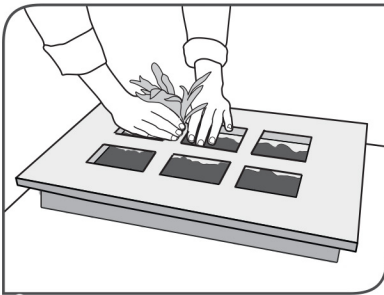

Step 1: With the POD planter laying on a flat, horizontal surface, make sure the moisture mats are flat along the back of the POD and run up along the top to cover grommet hole.



Step 2: Plant POD planter on a flat surface by filling each POD with soil and the plants of your choice packing the soil down firmly.

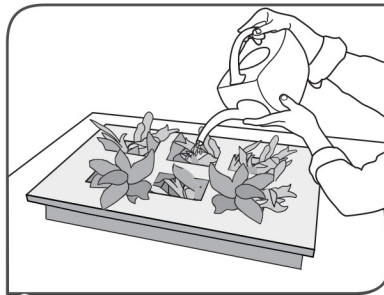

Step 3: Once the POD planter is planted, we recommend a thorough watering while laying flat. Let it sit for 2 - 3 hours before hanging.

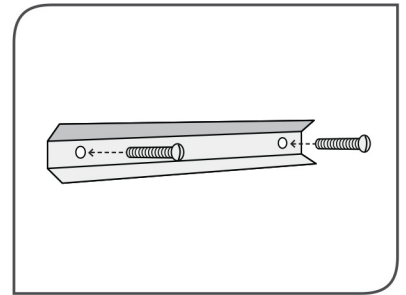

Step 4: Attach the mounting bracket to a secure vertical wall making sure to keep level. (screws not included)

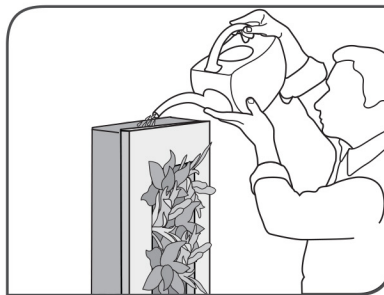

Step 5: Water your POD frame kit as needed based off plant recommendations. Plan to drain planter after a few hours after watering to see if any excess water drains after pulling the plugs along the bottom of planter.